

Aluminum Capacitors Power Ultra High Ripple Current Snap-In for Solar



KEY BENEFITS

- Specified for 500 V, 50 °C operation
- Long useful life at 450 V, 105 °C
- Long useful life at 500 V, 50 °C with no ripple current applied
- Low ESR, high ripple current capability

APPLICATIONS

- Solar PV inverters
- Industrial motor control
- Power supplies

RESOURCES

- Datasheet: 193 PUR-SI Solar - <http://www.vishay.com/doc?28407>
- For technical questions contact aluminumcaps2@vishay.com



Aluminum Capacitors Power Ultra High Ripple Current Snap-In for Solar

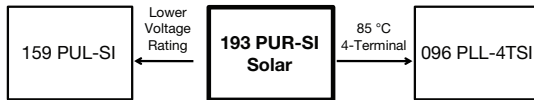

Fig. 1



QUICK REFERENCE DATA	
DESCRIPTION	VALUE
Nominal case size (D x L in mm)	35 x 30 to 35 x 60
Rated capacitance range, C_R	220 μ F to 560 μ F
Tolerance on C_R	± 20 %
Rated voltage, U_R	500 V
Rated temperature range	- 40 °C to + 50 °C
Category voltage, U_C	450 V
Category temperature range	- 40 °C to + 105 °C
Useful life at U_C , 105 °C, I_R applied	6000 h
Endurance at U_R , 50 °C, no ripple applied	5000 h
Shelf life at 0 V, 105 °C	1000 h
Based on sectional specification	IEC 60384-4/EN130300
Climatic category IEC 60068	40/105/56
Max. RMS value of ripple voltage	12 V

MARKING

The capacitors are marked (where possible) with the following information:

- Rated capacitance (in μ F)
- Tolerance code on rated capacitance, code letter in accordance with IEC 60062 (± 20 %)
- Rated voltage (in V)
- Two digit date code, in accordance with IEC 60062
- Name of manufacturer
- Code for factory of origin
- “-” sign to identify the negative terminal, visible from the top and side of the capacitor
- Code number
- Climatic category in accordance with IEC 60068
- “LL” for long life grade

DIMENSIONS in millimeters AND AVAILABLE FORMS

TWO TERMINAL SNAP-IN

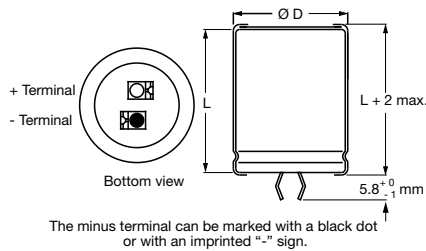

Fig. 2 - Two terminal snap-in

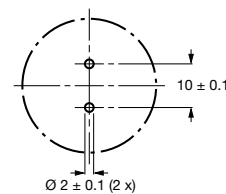

Fig. 3 - Mounting hole diagram

Table 1

DIMENSIONS in millimeters, MASS AND PACKAGING QUANTITIES					
NOMINAL CASE SIZE	$\varnothing D_{max.}$	$L_{max.}$	MASS (g)	PACKAGING QUANTITIES (unit per box)	CARDBOARD BOX DIMENSIONS L x W x H
35 x 30	36	32	40	50	390 x 198 x 44
35 x 40	36	42	56	50	390 x 198 x 54
35 x 45	36	47	64	50	390 x 198 x 59
35 x 50	36	52	72	50	390 x 198 x 64
35 x 60	36	62	88	50	390 x 198 x 74

Note

- Other case sizes, terminations and capacitance values available on request.

Revision 21-Jun-12